



Body: **Steel**
Zinc plated
Flat head





Hülse: **Stahl**
Verzinkt
Flachkopf

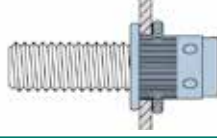
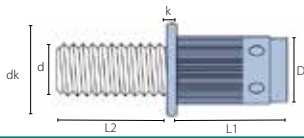

Cuerpo: **Acero**
Cincado
Cabeza ancha

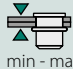

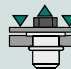
d	D Ø	L1xL2	 min - max	 mm	dk Ø	k max.	 [Nm]	 [N]	code
	mm	mm	mm	mm	mm	mm			
M4	5.4	8.0 x 10	0.5 - 2.0	5.5	8.0	0.5	4.0	5000	02ST10F0411
		8.0 x 15	0.5 - 2.0						02ST10F0412
		9.0 x 10	2.0 - 3.0						02ST10F0421
		9.0 x 15	2.0 - 3.0						02ST10F0422
M5	6.5	9.0 x 10	0.5 - 2.0	6.6	9.0	0.8	6.0	8000	02ST10F0511
		9.0 x 15	0.5 - 2.0						02ST10F0512
		10.5 x 10	2.0 - 3.5						02ST10F0521
		10.5 x 15	2.0 - 3.5						02ST10F0522
M6	7.7	10.0 x 10	0.5 - 2.5	7.8	10.0	1.0	11.0	9500	02ST10F0611
		10.0 x 15	0.5 - 2.5						02ST10F0612
		11.5 x 10	2.5 - 4.0						02ST10F0621
		11.5 x 15	2.5 - 4.0						02ST10F0622
M8	9.8	12.5 x 15	1.0 - 3.0	9.9	12.0	1.5	24.0	12000	02ST10F0811
		12.5 x 20	1.0 - 3.0						02ST10F0812
		15.5 x 15	3.0 - 5.0						02ST10F0821
		15.5 x 20	3.0 - 5.0						02ST10F0822